



Thank you!

Thank you for ordering a Downloadable WOOD PLAN. We hope you enjoy being a part of this new online experience and that you have fun building your wood-working project.

Please remember that this copyrighted material is for your use only. It is unlawful to share this file with someone else or to reprint it in any form.

Bill Krier
Editor
WOOD® magazine

Adobe Acrobat Troubleshooting Guide

*If you can read this page, your Acrobat program is working correctly!
But you may still have problems or specific issues such as printing and
saving your Downloadable WOOD PLAN.*

My printer won't print the text correctly

Almost all printing problems are due to not enough free system resources memory. The files are very memory intensive since they include graphics, text, and photos. Close all other programs/applications and print directly out of the Acrobat Reader program, not your Web-browser.

Patterns are not printing full size

Make sure your printer is set to print at 100% and that "print to fit" is not checked. These settings are selected in the printer setup or printer options.

I can't save my file now that it's downloaded

You must save the plan when you download the file. Download the file again, except this time try right-clicking on the red download button. A menu window will open. Select "Save target as" or "Save link as" to save the file to your hard drive. Once saved, you can open it with Adobe Acrobat Reader.

For more details on using Adobe Acrobat Reader please visit our online help section at:
<http://woodstore.woodmall.com/clicherforde.html>



Full-Service Workbench with a twist

At the heart of any good shop lies a great workbench. With that in mind, we went all out to design the unit shown here. On the next few pages, you'll learn how to build the end cabinets, drawers, and laminated benchtop. Then, in another downloadable plan, we'll show you one of the center cabinets with the lift-up router table in it. And finally, in that same plan, we'll show this same cabinet with a rotating top for mounting a benchtop tool.

To customize our modular workbench, we included as a separate downloadable plan a flip-up router table in one cabinet as shown above right and a lift-up scrollsaw table as shown bottom right.

Bill of Materials

Part	Finished Size			Mati.	Qty.	Part	Finished Size			Mati.	Qty.
	T	W	L				T	W	L		
CARCASE AND BASES						DRAWER BOTTOMS AND FRONTS					
A top & bottom	¾"	23"	23½"	MF	4	T bottoms	¼"	21½"	22½"	HB	8
B sides	¾"	23¾"	31¾"	MF	4	U drawers 1, 2, & 3	¾"	3¾"	24"	MF	3
C back	¾"	23½"	31¾"	MF	2	V drawer 4	¾"	4¾"	24"	MF	1
D shelf	¾"	22¾"	23"	MF	1	W drawer 5	¾"	6¾"	24"	MF	2
E front & back	¾"	4"	23½"	MF	4	X drawer 6	¾"	10"	24"	MF	2
F sides	¾"	4"	19"	MF	4	BENCHTOP					
G cleats	¾"	4"	23½"	MF	4	Y top	1½"	23¾"	96"	LMF	2
H banding	¾"	¾"	22½"	H	1	Z banding	¾"	1½"	97½"	H	1
I banding	¾"	¾"	15"	H	2	AA banding	¾"	1½"	24½"	H	2
DRAWER 1						BB back	¾"	5¼"	97½"	H	1
J front & back	½"	1¾"	20¾"	BP	2	CC spacer	¾"	4½"	7"	H	1
K sides	½"	1¾"	22½"	BP	2	<p>Materials Key: MF–medium density fiberboard, H–hardboard, BP–birch plywood, HB–hardboard, LMF–laminated medium density fiberboard.</p> <p>Supplies: #8×1", #8×1¼", #8×1½", #8×2" flathead wood screws; 8–3¾" pulls; 8 pair of 22" bottom-mount drawer guides; primer; paint; polyurethane. For the bench vise (we used a Wilton 4×7" pivot-jaw vise), 4–¾×3" lag screws with flat washers.</p> <p>Buying Guide Vise. Wilton 4×7" pivot-jaw woodworking vise. Maximum opening 10", weighs 29 lbs. Enclosed spindle prevents sawdust from entering threads. Part no. 126504PR. Woodcraft, 210 Wood County Industrial Park, P.O. Box 1686, Parkersburg, WV 26102-1686. Call 800/225-1153 for current price.</p>					
DRAWERS 2 & 3											
L front & back	½"	2¼"	20¾"	BP	4						
M sides	½"	2¼"	22½"	BP	4						
DRAWER 4											
N front & back	½"	3¼"	20¾"	BP	2						
O sides	½"	3¼"	22½"	BP	2						
DRAWER 5											
P front & back	½"	4½"	20¾"	BP	4						
Q sides	½"	4½"	22½"	BP	4						
DRAWER 6											
R front & back	½"	8¼"	20¾"	BP	4						
S sides	½"	8¼"	22½"	BP	4						

CUTTING DIAGRAM

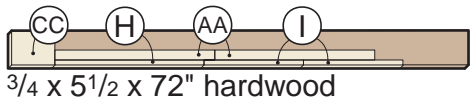

3/4 x 5 1/2 x 72" hardwood



3/4 x 7 1/4 x 120" hardwood

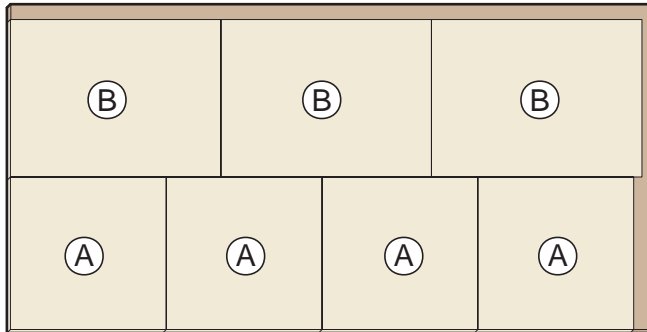

3/4 x 49 x 97" medium density fiberboard (*MDF)



3/4 x 49 x 97" medium density fiberboard (*MDF)

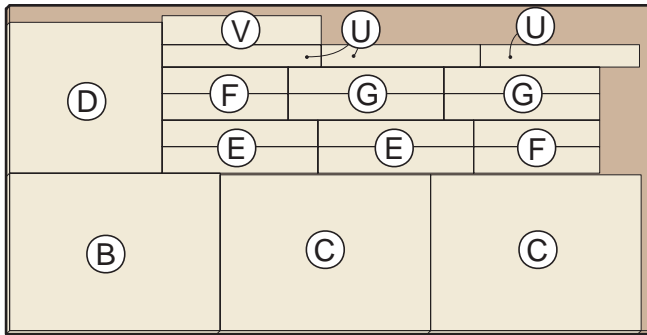

3/4 x 49 x 97" medium density fiberboard (*MDF)

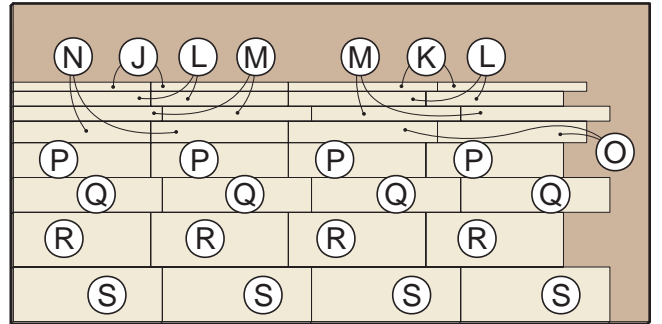

1/2 x 48 x 96" birch plywood

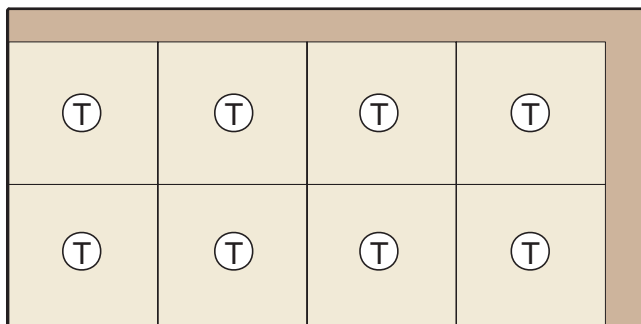

1/4 x 48 x 96" hardboard

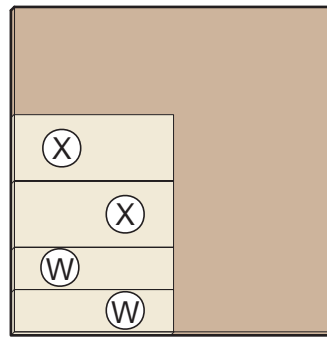

3/4 x 49 x 48 1/2" medium density fiberboard (*MDF)

*Standard 4x8 sheet particleboard or plywood will work in place of MDF

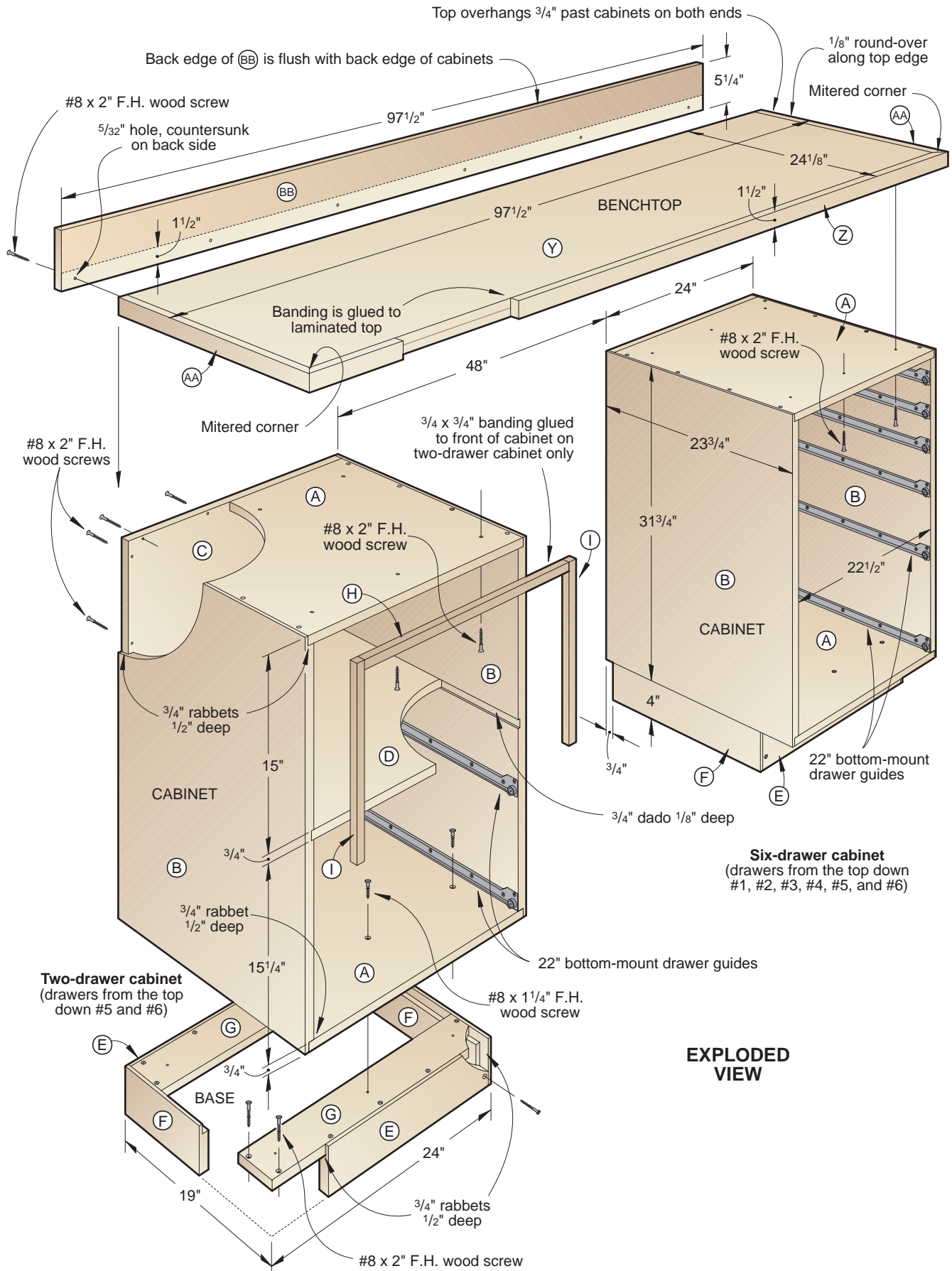

Six-drawer cabinet
(drawers from the top down #1, #2, #3, #4, #5, and #6)

Two-drawer cabinet
(drawers from the top down #5 and #6)

EXPLODED VIEW

Start with the two basic end cabinets

1 Cut the cabinet tops and bottoms (A), sides (B), backs (C), and shelf (D) to the sizes listed in the Bill of Materials from $\frac{3}{4}$ " medium density fiberboard (MDF). As noted on the Cutting Diagram, MDF measures 1" wider and longer than regular 4x8' sheet goods. Birch plywood would also work fine for these pieces.

2 Cut the rabbets and dadoes in the sides (B) where shown on the Exploded View drawing. Note that only the left-hand cabinet is dadoed for the shelf (D).

3 Glue and clamp the cabinets (A, B, C, D) together in the configuration shown on the Exploded View, checking for square.

4 Cut the base front and back (E), sides (F), and cleats (G) to size.

5 Cut the rabbets in parts E and F where shown on the Exploded View drawing. Glue and screw the bases (E, F, G) together in the configuration shown. Fill the counterbored screw holes with wood filler, and later sand

smooth with 220-grit sandpaper. **6** Cut the left-hand cabinet front banding strips H and I to size. The thickness of the strips needs to be the same as the thickness of the MDF or plywood. Glue the strips to the front of the cabinet where shown on the Exploded View.

7 Using the Side Section Views for reference, drill the mounting holes and screw the bases to the bottoms of the cabinets. Note that the back edge of the cabinet overhangs the base by $\frac{3}{4}$ ".

Add the drawers for the two cabinets next

1 From $\frac{1}{2}$ " stock (we used birch plywood), cut all the drawer fronts (J,L,N,P,R), and sides (K,M,O,Q,S) to the sizes listed in the Bill of Materials. Cut the drawer bottoms (T) from $\frac{1}{4}$ " hardboard and false fronts (U,V,W,X) from $\frac{3}{4}$ " MDF.

2 Using the dimensions on the Drawer drawing, cut the rabbets in the drawer sides.

3 Drill countersunk mounting holes, and glue and screw each drawer (not

including the false drawer fronts) together, measuring diagonally to check for square.

4 Using the instructions supplied with the drawer guides and the dimensions on the Side Section Views, screw the guides to the bottom side edge of each drawer. Make sure each guide is flush with the front of the drawer box. Mount the mating guide hardware to the inside of the end cabinets.

5 Drill counterbored shank holes on the inside face of the false drawer fronts. Attach a wire pull to each false front. Fit the drawers in place in the cabinets. Apply two pieces of double-faced tape to the back side of each false drawer front, and adhere them to the front of the drawer boxes leaving a $\frac{1}{8}$ " gap between the drawers. See the Side Section Views for reference.

6 Remove the drawers from the cabinets. Then, remove the false drawer fronts from the drawer boxes, numbering the corresponding false fronts and boxes for ease when reattaching them later. Paint the cabinets, bases, and drawer fronts.

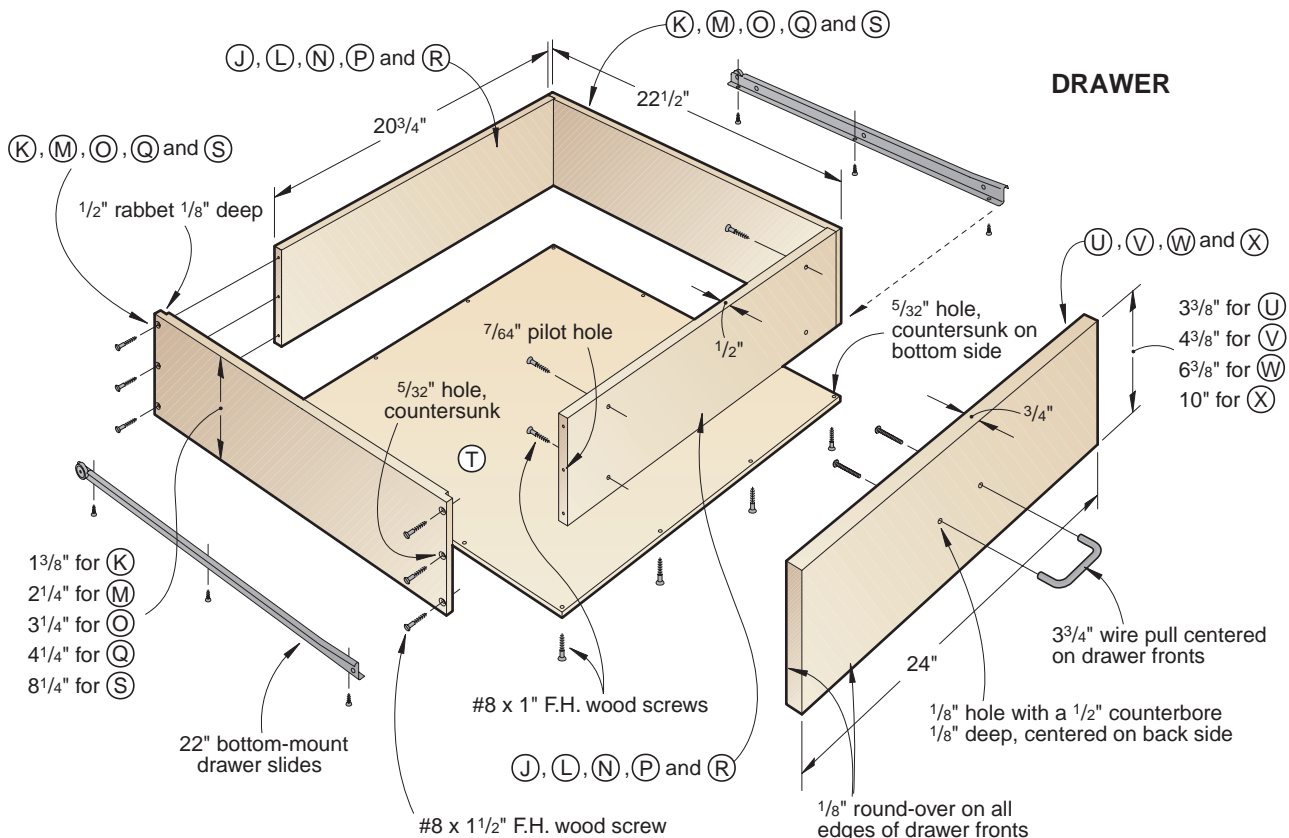

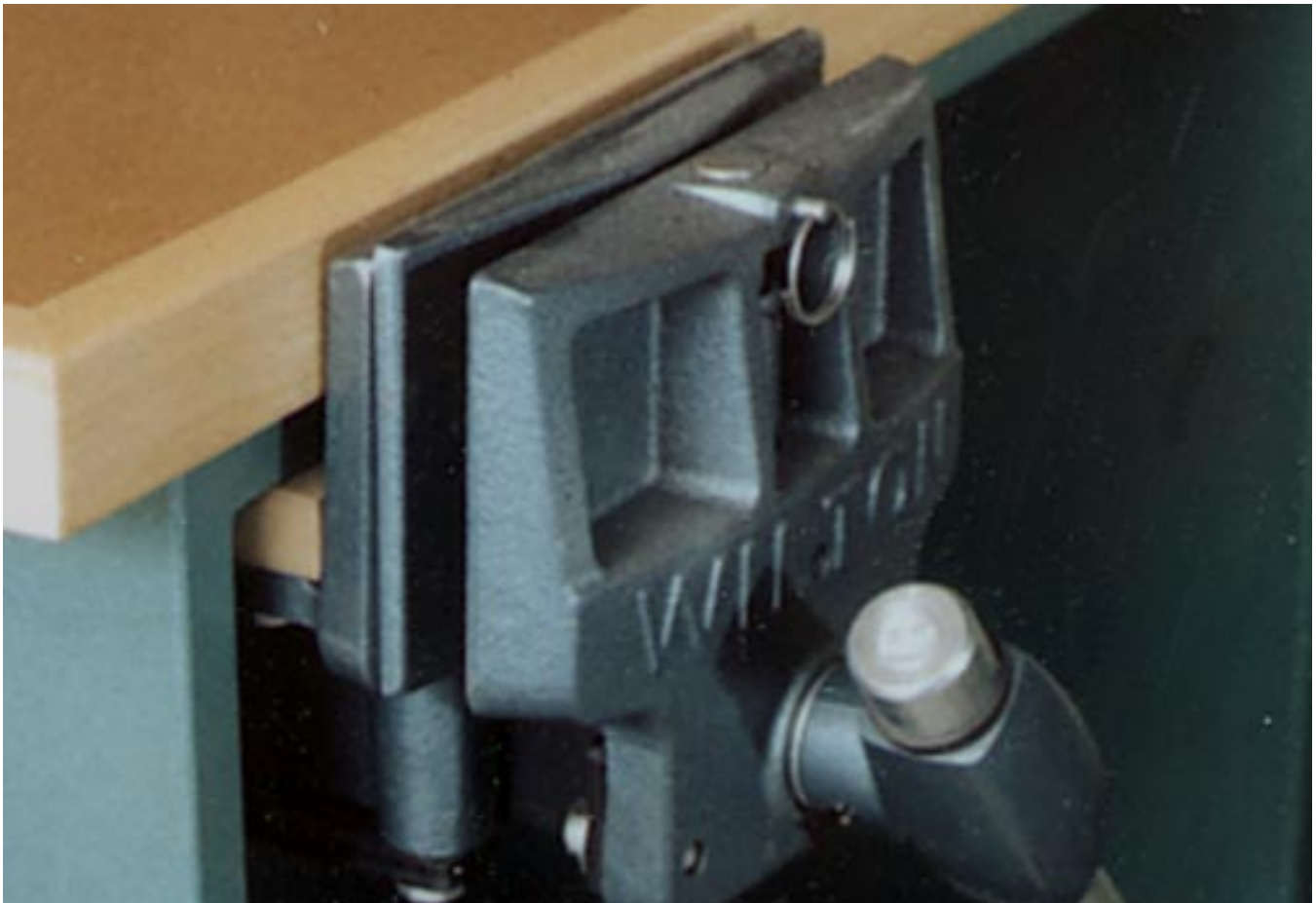

A pivot-jaw vise mounts easily to the bottom side of the benchtop.

(We used Hammerite, a new type of paint with a textured finish. See our method for applying this product in issue 100, Nov. 1997.)

Laminate a benchtop to take plenty of abuse

1 Cut two pieces of $\frac{3}{4}$ " medium density fiberboard (MDF) for the top (Y) to the size listed in the Bill of Materials plus 1" in length and width. Spread an even layer of glue over the mating surfaces, and glue and clamp the two pieces together, keeping the edges and ends flush. (Since it's difficult to apply clamping pressure in the middle of this large panel, we drilled countersunk mounting holes, and drove $1\frac{1}{4}$ " flathead wood screws from the bottom side of the panel to hold the two sheets tightly together.)

2 Trim the $1\frac{1}{2}$ "-thick top (Y) to the finished size ($23\frac{3}{8}\times 96$ ") listed in the Bill of Materials.

3 Cut and miter-cut the banding pieces (Z, AA) to size, and glue them to the top where shown on the Exploded View drawing. Next, cut the backboard (BB) to size. Drill mounting holes, and screw it to the back of the laminated top where shown on the drawing.

4 Remove the guides from the drawers. Apply a clear finish (we used polyurethane) to the benchtop and drawers. Later, reattach the painted false drawer fronts to the clear-coated drawers. Reattach the drawer guides.

Add the vise for plenty of holding power

1 With the aid of a helper, position the end cabinets and laminated top in position in your shop. Working from inside the cabinets, drill mounting holes and secure the laminated top to the top of the cabinets with $\#8\times 2$ " wood screws.

2 See the Buying Guide for the vise we used, or select your own model. Cut the spacer (CC) to size, and attach it to the bottom of part A where shown on the Vise detail on the opposite page. Using the same drawing for reference, drill the mounting holes, and use lag screws to secure the vise to the workbench assembly. 🌲

Produced by Marlen Kemmet
 Project Design: Jan Hale Svec
 Illustrations: Kim Downing; Lorna Johnson
 Graphic Design: Jamie Downing
 ©COPYRIGHT MEREDITH CORPORATION 1998

The purchase of these plans does not transfer any copyright or other ownership interest in the plans, the design, or the finished project to the buyer. Buyer may neither reproduce the plans for sale nor offer for sale any copies of the finished project.

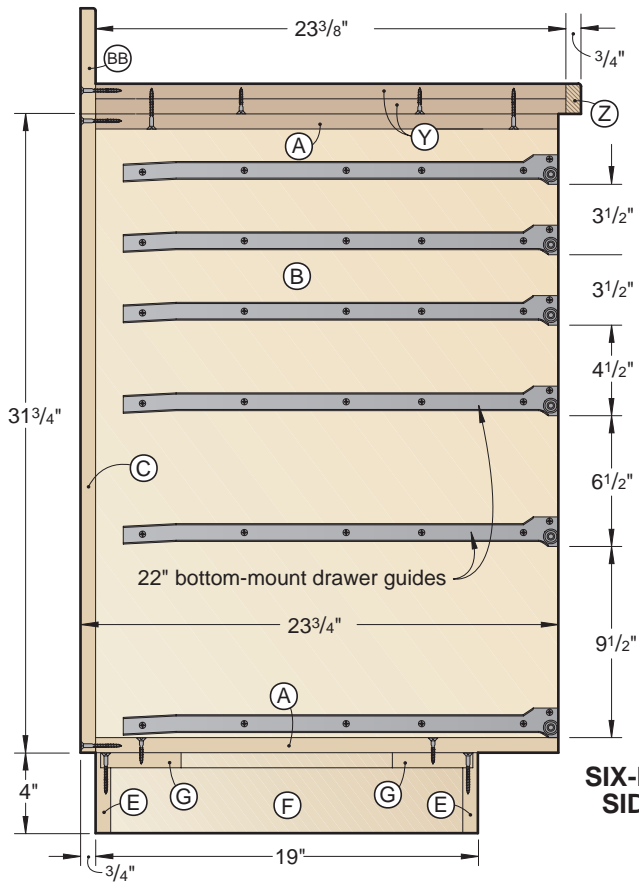

**SIX-DRAWER CABINET
SIDE SECTION VIEW**

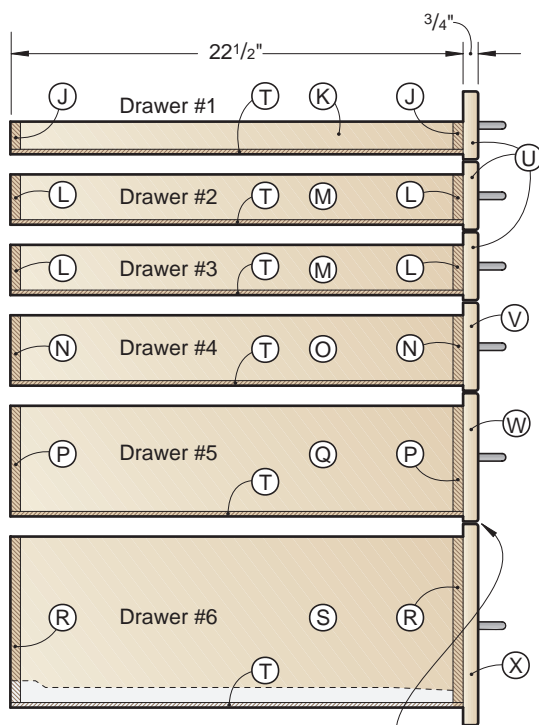

Approximately 1/8" gap between drawer fronts

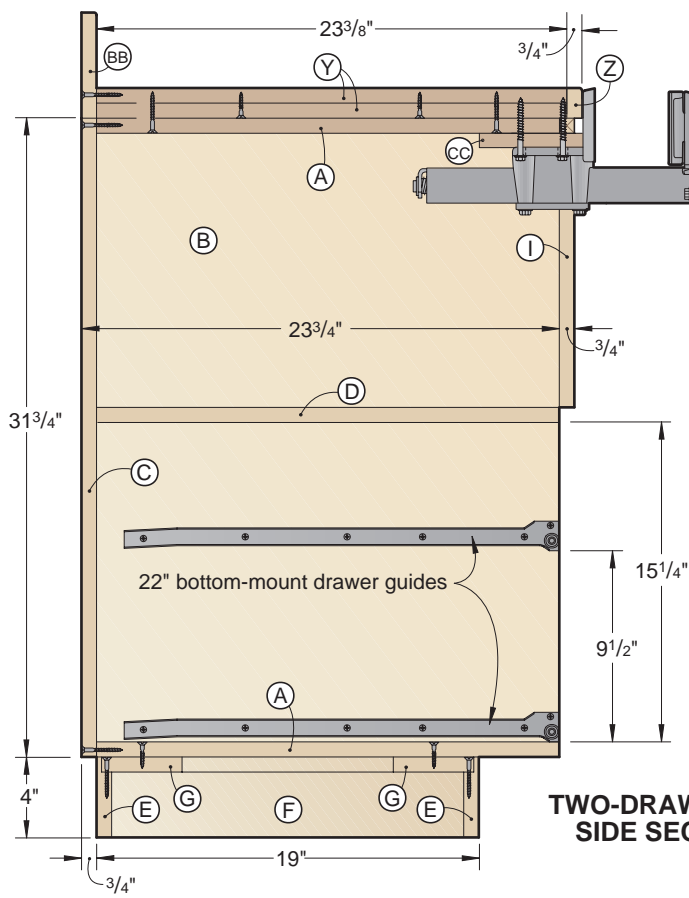

**TWO-DRAWER CABINET
SIDE SECTION VIEW**

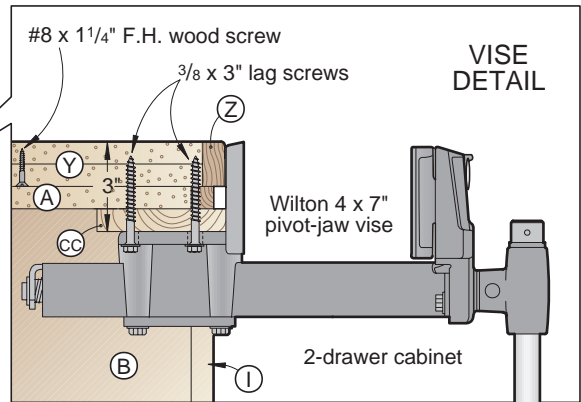

**WISE
DETAIL**

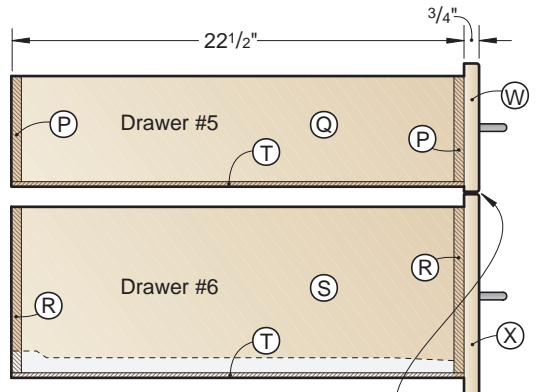

Approximately 1/8" gap between drawer fronts

WOODMALL® The Internet's Largest Source for Woodworking Tools and Accessories

<http://www.woodmall.com>

Thanks for your order!

Now that you've got a detailed plan to build that perfect project, visit the WOOD MALL for the internet's largest source for woodworking tools and accessories. The WOOD MALL offers:

- Over two dozen woodworking-related stores
- More than 50,000 tools & accessories
- 24-Hour shopping
- Special sales & closeouts
- Nearly 40 tool comparison charts
- **FREE** monthly woodworking seminar

Visit Today! <http://www.woodmall.com>



Current issue not shown

Like no other magazine, WOOD helps you make the most of your shop time ... takes your skills to the next level. Every issue of WOOD is jam-packed with ...

- Smart tips, tricks, secrets and shortcuts that save you time, effort and money
- Valuable tool reviews with at-a-glance information charts that give you helpful product comparisons
- Giant full-size pattern pull-outs
- Crystal-clear step-by-step instructions, exploded diagrams, finishing secrets and techniques for that professional look – everything you need to bring out your woodworking genius!

- 2 years (14 issues) just \$44 **SAVE \$39.30 off single-copy rate!**
- 1 year (7 issues) just \$26 **SAVE \$15.65 off single-copy rate!**
- Payment Enclosed Bill Me

Fill out information below and mail to: WOOD® Magazine P.O. BOX 37439, Boone, IA. 50037-0439 or Subscribe Online at <http://www.woodmagazine.com/subscribe>

My Name (please print) _____

Address _____ **Apt. #** _____

City _____ **State** _____ **Zip** _____

Canadian Orders: Fill in the form above. Your rate will be 1 year (7 issues) for \$41 – SAVE \$14.65, or 2 years (14 issues) for \$67 – SAVE \$44.30. Prices include postage; 7% GST or 15% HST is added. #12348 2887 RT

U.S. and Canadian subscribers: You also may order by credit card. Call toll free 1-800-374-9663 weekdays from 7 a.m. to 10 p.m. Central Time; Saturdays, 8 a.m. to 3 p.m.; Sundays, 9 a.m. to 3 p.m.

Other International Orders: 2 years for \$89 U.S. or 1 year for \$49 U.S.; prices include postage. To order by credit card call 515/246-6952 during the same hours as listed above (toll charged). Or complete this form; mail with US funds to: WOOD® Magazine, P.O. Box 37439, Boone, IA. 50037-0439 USA.

Your Money-Back Guarantee: You must be satisfied with your subscription or you can get a refund for all unmailed issues.

WOOD® Magazine is published 7 times a year. Savings are based on \$5.95 U.S., \$7.95 Canadian single-copy rate. The first issue mails in 8-12 weeks. Subscription prices subject to change.