

THIS DOCUMENT IS THE PROPERTY OF LYTRON, INC. AND REPRESENTS A PROPRIETARY ARTICLE ON WHICH LYTRON, INC. RETAINS ANY AND ALL PATENT AND OTHER RIGHTS, INCLUDING EXCLUSIVE RIGHTS OF USE AND/OR MANUFACTURE AND/OR SALE. POSSESSION OF THIS DOCUMENT DOES NOT CONVEY ANY PERMISSION TO REPRODUCE THE DOCUMENT OR MANUFACTURE THE ARTICLE OR ARTICLES SHOWN THEREIN.

ZONE		LTR	REVISIONS DESCRIPTION	DATE	SOLIDWORKS APPROVED
A			INITIAL RELEASE	JFP 3/10/00	APT
B			REV'D & REDRAWN ADDED NOTES AND INSPECTION MARKS AND DATUMS	CDM 10/26/01	PRV

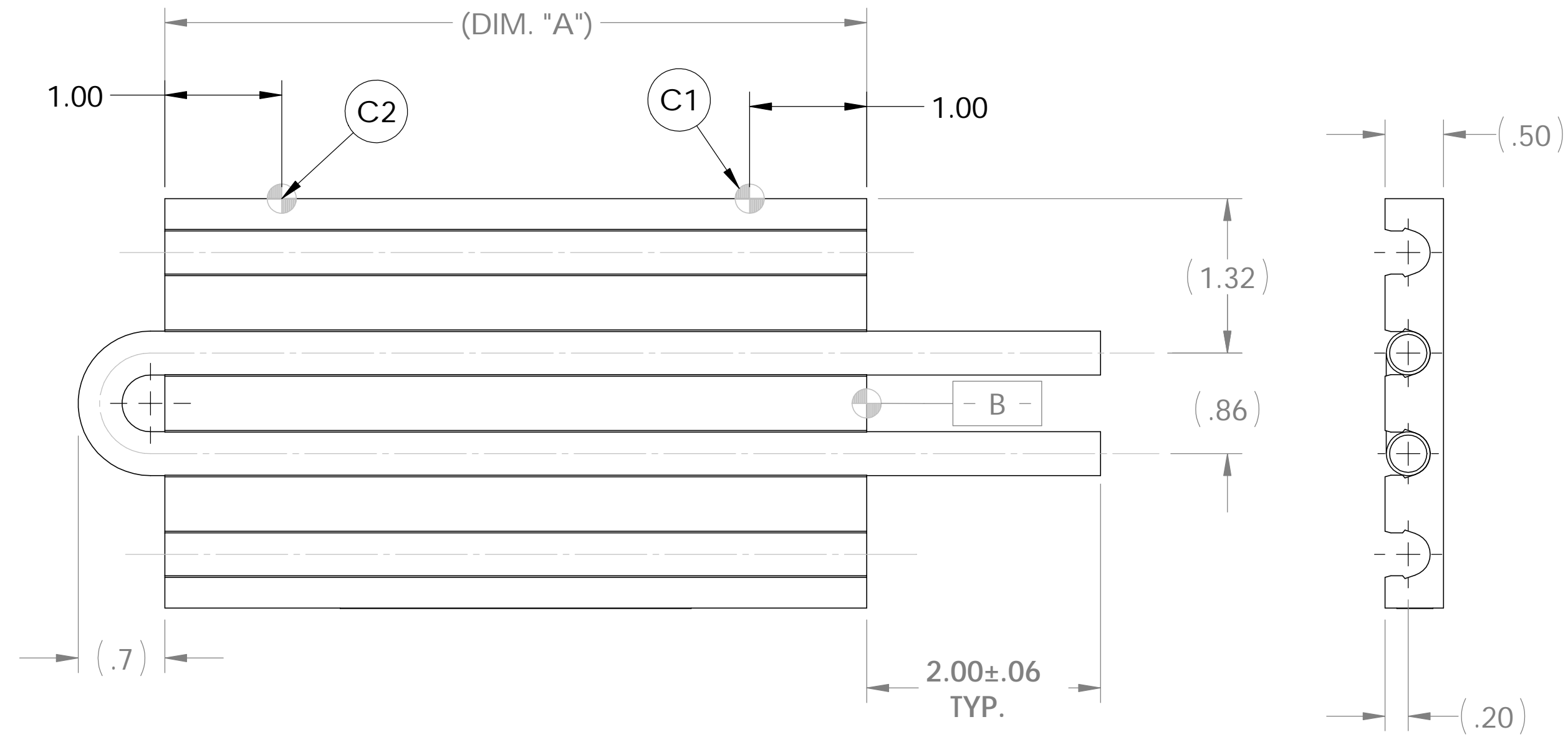

### DOUBLE PASS

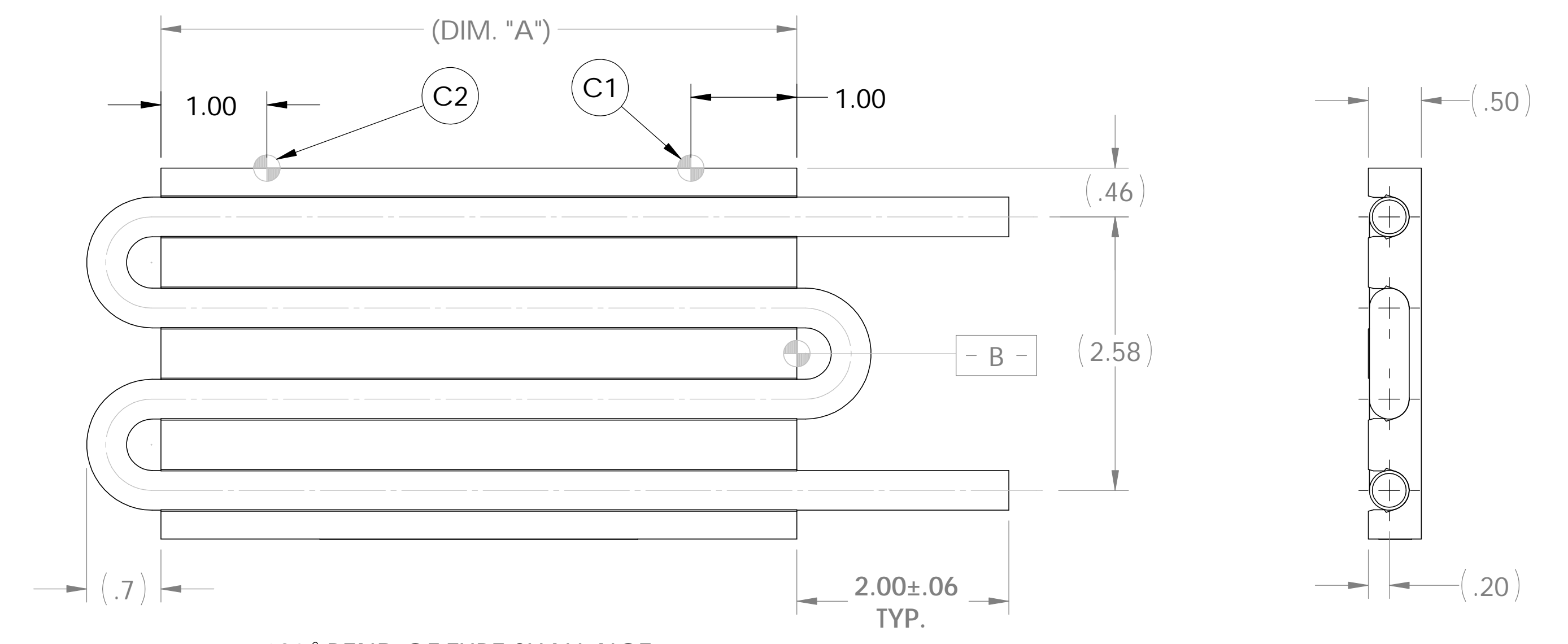

### QUADRUPLE PASS

LYTRON P/N	(DIM. "A")	TUBING MAT'L	IO FITTING STYLE	CONFIGURATION
CP10G01	6.00	COPPER	STRAIGHT	DOUBLE PASS
CP10G02	6.00	COPPER	BEADED	DOUBLE PASS
CP10G03	6.00	STAINLESS STEEL	STRAIGHT	DOUBLE PASS
CP10G04	6.00	STAINLESS STEEL	BEADED	DOUBLE PASS
CP10G05	12.00	COPPER	STRAIGHT	DOUBLE PASS
CP10G06	12.00	COPPER	BEADED	DOUBLE PASS
CP10G07	12.00	STAINLESS STEEL	STRAIGHT	DOUBLE PASS
CP10G08	12.00	STAINLESS STEEL	BEADED	DOUBLE PASS
CP10G14	6.00	COPPER	STRAIGHT	QUADRUPLE PASS
CP10G15	6.00	COPPER	BEADED	QUADRUPLE PASS
CP10G16	6.00	STAINLESS STEEL	STRAIGHT	QUADRUPLE PASS
CP10G17	6.00	STAINLESS STEEL	BEADED	QUADRUPLE PASS
CP10G18	12.00	COPPER	STRAIGHT	QUADRUPLE PASS
CP10G19	12.00	COPPER	BEADED	QUADRUPLE PASS
CP10G20	12.00	STAINLESS STEEL	STRAIGHT	QUADRUPLE PASS
CP10G21	12.00	STAINLESS STEEL	BEADED	QUADRUPLE PASS

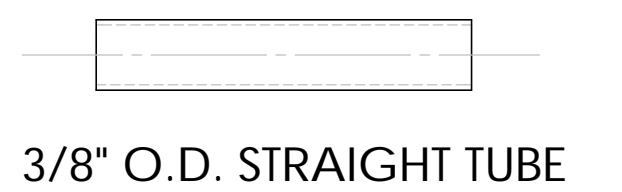
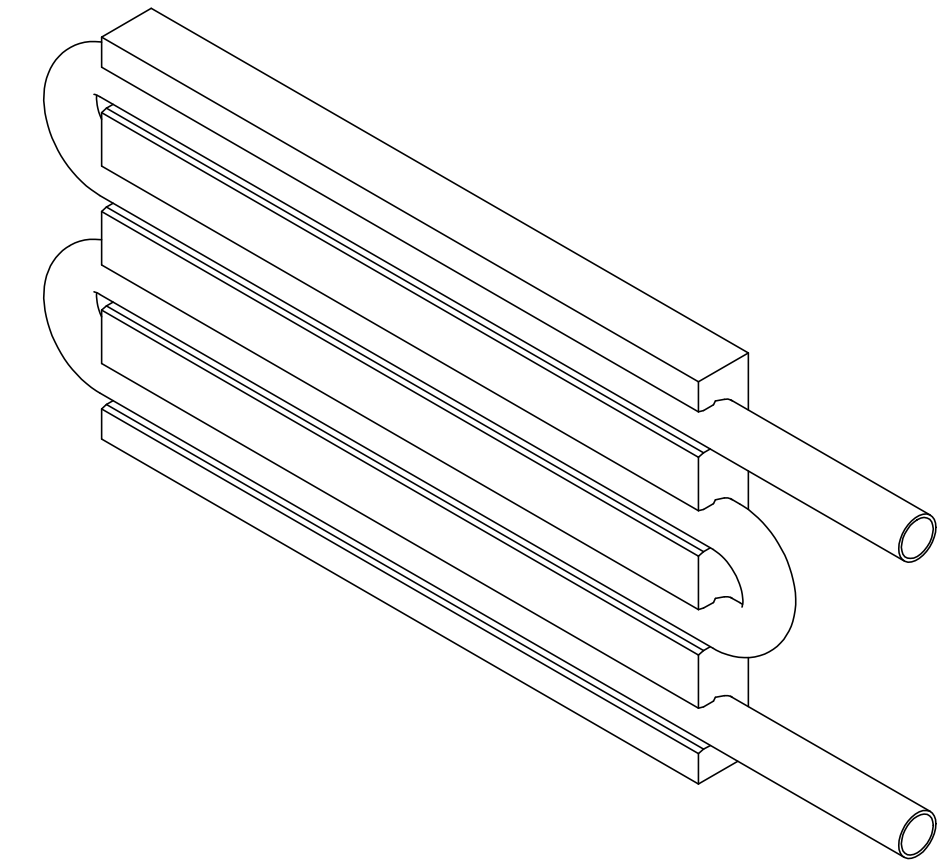
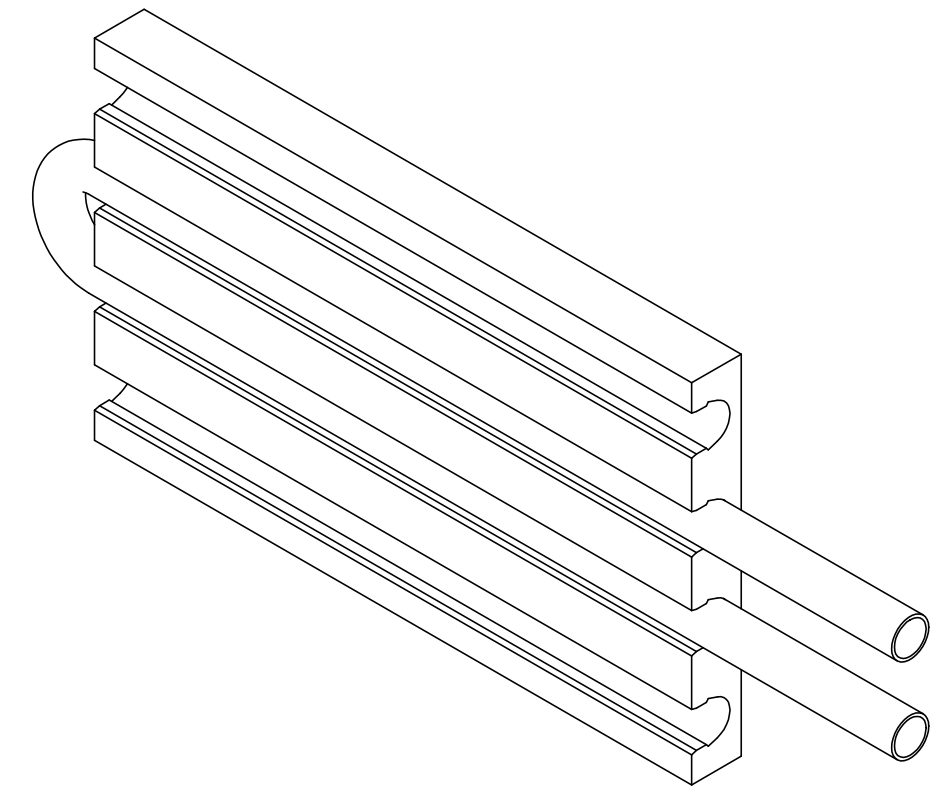

- NOTES:
- MATERIAL:  
PLATE: ALUMINUM  
TUBING CIRCUIT: STAINLESS STEEL OR COPPER.
  - FLATNESS .001/IN.
  - DRILLED AND TAPPED HOLES (THRU ONLY) ARE AVAILABLE IN THE FOLLOWING SIZES.  
DRILLED HOLES .09 - .375 DIAMETER  
TAPPED HOLES 4-40 - 3/8-24  
TAPPED HOLES (METRIC) M1.5 - M10
  - ALL HOLES ARE DIMENSIONED AND TOLERANCED AS SHOWN ON DRAWING.
  - LYTRON RECOMMENDS AVOIDANCE OF THE SLOTS WHEN CHOOSING A HOLE PATTERN.

QTY REQD	PART OR IDENT NO.	DESCRIPTION	ITEM NO
LIST OF MATERIALS OR PARTS LIST			
UNLESS OTHERWISE SPECIFIED		REDRAWN CMARSHALL DATE 10/26/01	<b>LYTRON INCORPORATED</b> WOBURN, MASSACHUSETTS DRAWING TITLE <b>COLD PLATE (PRESS-LOCK)</b>
ANGULAR DIMENSIONS + 5° SURFACE ROUGHNESS (3.2 μm) BREAK EDGES .010 (25mm) MAX. REMOVE ALL BURRS		DRAWN J PLOURDE 3/9/00	
TOLERANCE ON DECIMALS		APPROVED A THOMAS 3/10/00	
THIRD ANGLE PROJECTION		APPROVED	DO NOT SCALE THIS DRAWING
DIMENSIONS AND TOLERANCING ARE PER ANSI Y14.5		MATERIAL SEE TABLE	SIZE D
NEXT ASSY APPLICATION	USED ON	FINISH NONE	FSCM NO. 11245
		SCALE 1/1	DRAWING NO. C-CP10GXX
			REV B
			WT. SHEET 1 OF 1